

# AS 1 INDICATOR

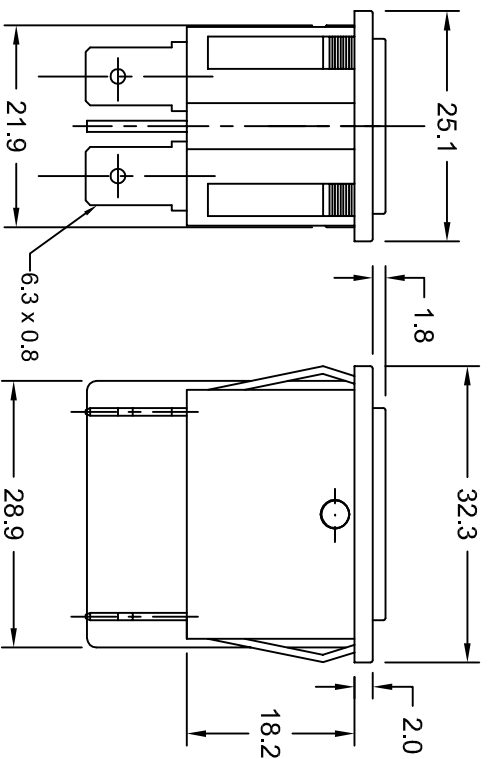

## PRINTING OPTIONS

## RATING

250V AC

### Indicator Electrical Circuit Diagram

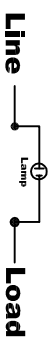

### Approvals

**CE** - As per IEC / EN 61058 - 1

Reference Standards : IEC / EN 61058 - 1  
UL - 1054

Body Colour	Cap Colour
Black	Red
White	Amber
	Green
	Blue

### MATERIAL OF CONSTRUCTION

**BODY** : Nylon 66 ( Unfilled )  
Flammability UL 94 V-2

**CAP** : Polycarbonate  
Flammability UL 94 V-2

**CONTACTS** : Silver / Silver Alloy  
Copper

**TERMINALS** : Copper / Copper Alloy

**RoHS Compliant**

### PANEL CUT-OUT SIZE

### BEZEL

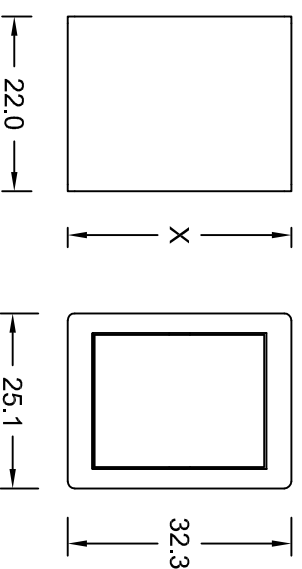

### DIMENSIONS FOR SNAP - IN MOUNTING

PANEL THICKNESS	DIMENSION X
0.75 - 1.25	30.0
1.25 - 2.00	30.2
2.00 - 3.00	30.4

\* Panel Cut-outs must be punched in the direction of insertion

**Astron Switch Craft**